

# Typ 0 601 587 5. . = GST 60 PBE

Stand   
 Issue  97-10-13

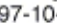

Umbau von  
 1587 5. . in 1587 6. .  
 Satz nur vollständig  
 verwenden

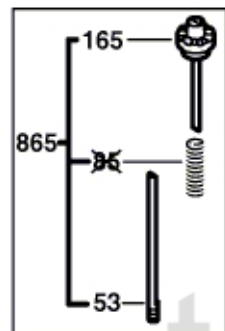
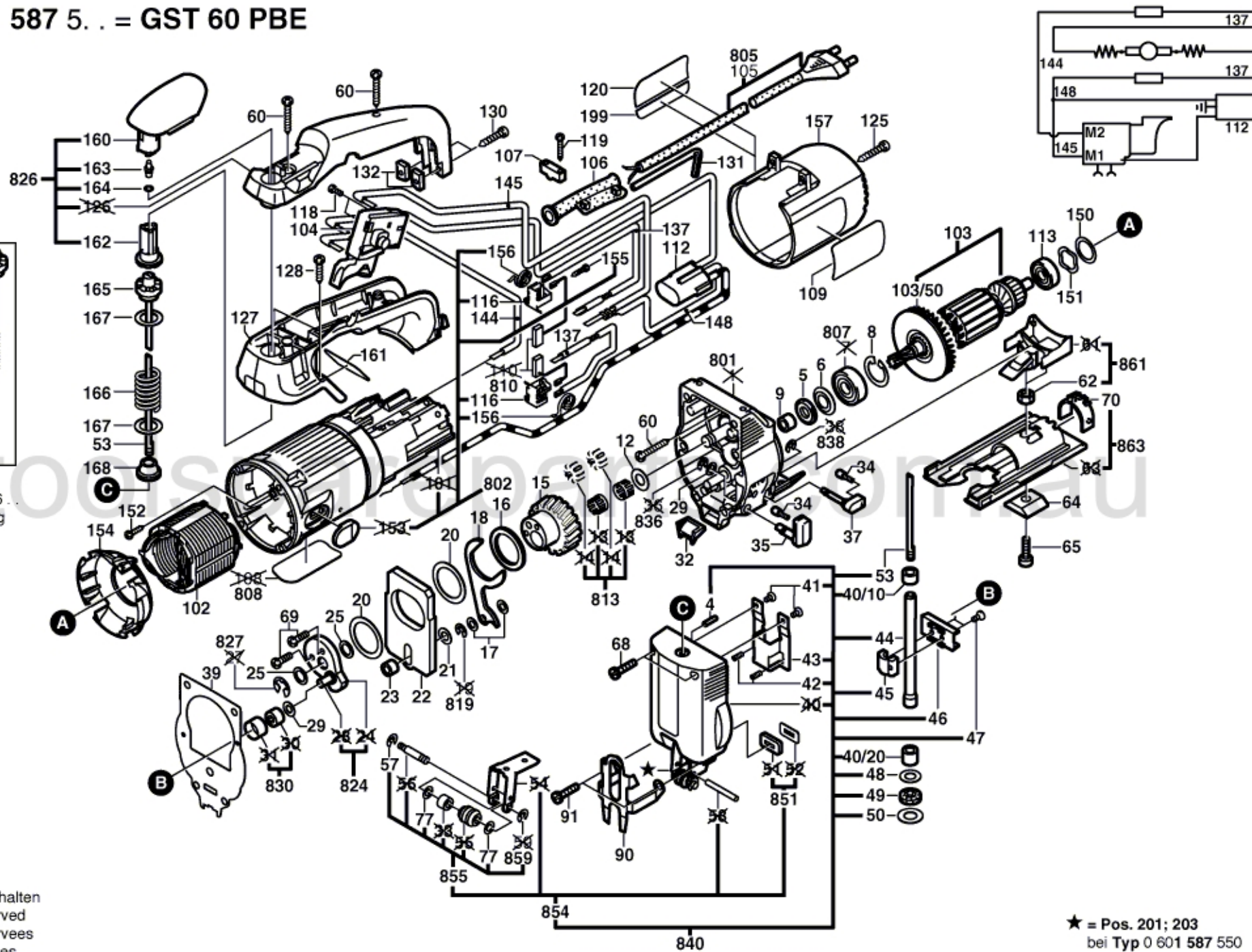

Änderungen vorbehalten  
 Modifications reserved  
 Modifications reserves  
 Salvo modificaciones

★ = Pos. 201; 203  
 bei Typ 0 601 587 550